

# Recommendations by the Quality Task Group (52): Requirements for Construction or Conversion of a Hospital Central Sterile Supply Department Part 2 – Staff and Material Routes

In this recommendation on the topic of "Requirements for Construction or Conversion of a Hospital Central Sterile Supply Department" we will discuss routes within the CSSD, while addressing also the various points of intersection.

The aim here is to safeguard the activities unfolding in the clean area and prevent contamination (microbial transmission, etc.) from the unclean area into other areas. In particular, → **SPATIAL SEPARATION** of the various areas can assure separation of contaminated, decontaminated and sterilised materials.

→ **SPATIAL SEPARATION** prevents contamination.

It is presupposed that there is a changing room situated at a central or decentralised location, depending on the spatial or organisational circumstances of the respective establishment.

## Staff routes

The unclean area must be spatially separated from the clean area/sterile supplies' area. Ideally, there should be separate access facilities, including a changing room, as shown in the model staff and materials' flow chart below.

## Staff sluice

In line with the "Three-Route Sluice" principle, a distinction is made between the following:

- Outer staff sluice: Changing out of and into work or outdoor clothing
- Inner staff sluice: Changing into department clothing (clean/unclean), Changing out of clean-area department clothing
- Unclean staff sluice: changing out of unclean department clothing, access to outer staff sluice

## Staff sluices based on the "Three-Route Sluice" principle

If a staff sluice as specified above is not feasible for structural reasons, the following must be done:

- An "unclean changing room (gown sluice)" must be installed before the unclean area. "Unclean changing room (gown sluice)" means: Donning or removing personal protective gear, including hand disinfection and changing, and as applicable changing of → **DEPARTMENT CLOTHING**.
- A "clean changing room (gown sluice)" must be installed before the sterile supplies' area. "Clean changing room (gown sluice)" means: At least hand disinfection, possibly compliance with the personal hygiene requirements of the operating theatre if there is direct access to the OR area

→ **DEPARTMENT CLOTHING** is used only in a defined area.

## Toilets

- Access via staff sluice

## Office

- Access from clean area
- Visitors' access from outside, with barrier to inner zone

## Recreation room

- Access from clean area

## Material routes

The material routes are also depicted in the following model staff and materials' flow chart.

**Hygiene requirements must be observed while transporting materials too.**

## Unclean incoming goods zone

- Delivery of supplies to be reprocessed
- Waste disposal to disposal room

**Unclean area**

- Washer-disinfector loading zone: cleaning, disinfection and drying
- Manual workstation (pre-cleaning, etc.)
- Storage area (transport systems, etc.)
- Load-through WD and/or tunnel washers
- Manual handover (pass-through)
- Container/ trolley washing facility

**Clean area**

- Removal of reprocessed supplies
- Release after decontamination and drying
- Distribution of decontaminated supplies for further processing
- Return loading trolleys to WD
- Return facility for supplies with residual soils from clean area to unclean area
- Packing station
- Return decontaminated materials to users
- Loading zone for steriliser **Note:** materials supplied from the outside only for sterilisation are delivered in the same way as consumables; if necessary they are packed, labelled and made ready for sterilisation to that effect.
- Load-through sterilisers

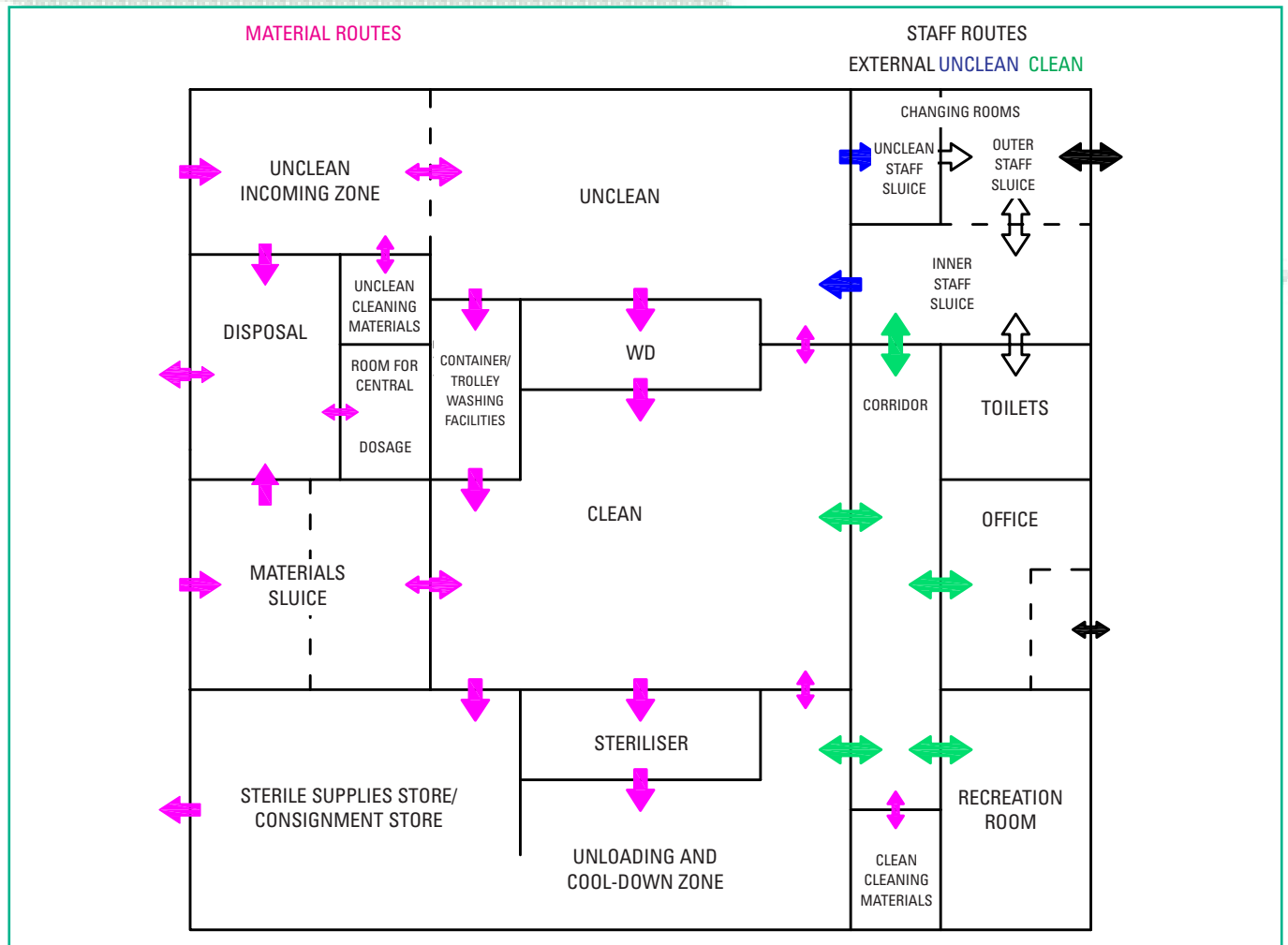

**Fig. 1:** Staff and material routes flow chart of a Central Sterile Supply Department (CSSD)

**Unloading and cool-down zone**

- Unloading and cooling down of sterile supplies
- Release after sterilisation
- Return loading trolleys to steriliser
- Return materials that have not been released
- Return and distribute sterile supplies

**Sterile supplies' store/consignment store**

- Provision of reprocessed transport trolleys
- Storage of sterile supplies
- Consignment store

**Disposal**

- Waste collection

**Unclean cleaning materials' room**

- Storage area for cleaning trolleys
- Exhaust

**Central dosage**

- Storage area for WD chemicals and trolley/container washing facilities and dosage system

**Materials' sluice**

- Incoming goods' zone
- Consumables' store

**Clean cleaning materials' room**

- Storage area for cleaning trolleys
- Cleaning detergents' store
- Exhaust

The routes described above are illustrated in the following model staff and materials' flow chart. Such an optimal room layout will not be possible in all cases when constructing or converting a CSSD. In such cases, alternative solutions must be found while paying attention to all specifications.

The forthcoming publication in this series will focus on the technical and functional aspects of workplace fittings. ◆

**Editor in Chief**

P. Heeg, Tübingen, Germany

**Editors**

P. Heeg, Tübingen (D), P. Hooper, Banbury (GB),  
W. Renders, Brugge (B)

**Advisory Editorial Board**

W. Accoe, Gent (B), M. Alfa, Winnipeg (CDN),  
M. Borneff-Lipp, Halle (D), E. Dönhöfer, Köln (D),  
D. Goulet, Lyon (F), P. Holland, Kingston-upon-Thames (GB),  
U. Junghanns, Köthen (D), S. Krüger, Grünendeich (D),  
H. Martiny, Berlin (D), A.P. Mercieca, Sydney (AUS),  
T. Miorini, Graz (A), E. Pfeifer, Waldkraiburg (D),  
K. Roth, Tübingen (D), A. Schneider, Pforzheim (D),  
G.A. Sills, Nottingham (GB), P.A. de Vries, Utrecht (NL),  
P. Weber, Winterthur (CH), T. Zanette, Tübingen (D)

Central Service is the official publication of the German Society for Sterile Supply e.V. (DGSV).

**Publisher**

mhp-Verlag GmbH, Geschäftsführer Andreas Klein,  
Marktplatz 13, D-65183 Wiesbaden  
© +49 (0) 611/505 93-31, Fax: -11, E-mail:  
info@mhp-verlag.de

**Editorial Staff**

Dr. Gudrun Westermann  
© +49 (0) 611/505 93-35, Fax: -11  
E-mail: ZentrSteril@mhp-verlag.de

**Advertising Sales**

Walter Bockemühl © +49 (0) 611/505 93-32



**Rate Card**

Rate card No. 15/2007

**Printing**

Druckerei Chmielorz GmbH,  
Ostring 13, D-65205 Wiesbaden-Nordenstadt

**Paper**

Terraprint mat "chlorine-free", 80 g/sq.m

**Publication Schedule**

Bimonthly: February, April, June, August, October, December

**Subscription Rates**

Single issue: € 8.85 (plus postage, tax included).  
Annual subscription rate (6 issues, postage and VAT included) Germany: € 57.30, Europe: € 65.70, World: (air mail) € 80.60.

Unless cancelled before August 31st of the current year, the subscription is automatically continued for another year. Subscription orders should be sent to the publisher.

**Copyright**

All rights reserved. No part of this publication may be reproduced, transmitted in any form or by any means without the prior written permission of mhp-Verlag GmbH. One photocopy of individual articles or parts thereof may be made for personal use only. © mhp-Verlag GmbH 2007

**Masthead**

**Trademarks**

The use of general descriptive names, trade names, trademarks, etc., even if these are not especially identified, is not to be taken as sign that such names may be used freely by anyone.

Editor in Chief, Editorial Board and publisher do not guarantee for articles published outside the editorial part of the journal (especially advertising, industrial information) contained in this journal. Authors who are mentioned with their full name and who are not member of the editorial staff publish articles in their own responsibility. Editors and publishers are not liable for these articles.

ISSN 0942-6086